

General Safety Information

- WARNING** – To avoid serious injuries:
- It is important to completely understand the operation of your bicycle's brake system. Improper use of your bicycle's brake system may result in a loss of control or an accident, which could lead to sever injury. Because each bicycle may handle differently, be sure to learn the proper braking technique (including bicycle control characteristics) and operation of your bicycle. This can be done by consulting your professional bicycle dealer and the bicycle owner's manual, and by practicing your riding and braking technique.
  - When securing the brake arm to the frame, be sure to use a brake arm clip that matches the size of the chainstay, and securely tighten them with the clip screw and clip nut to the specified tightening torque. Use a lock nut with a nylon insert (self-locking nut) for the clip nut. It is recommended that standard Shimano parts be used for the clip screw, clip nut and brake arm clip. In addition, use a brake arm clip that matches the size of the chainstay. If the clip nut comes off the brake arm, or if the clip screw or brake arm clip becomes damaged, the brake arm may rotate on the chainstay and cause the handlebars to jerk suddenly, or the bicycle wheel may lock and the bicycle may fall over, causing serious injury.
  - When installing the hub to the frame, be sure to install the correct non-turn washers to the left and right sides, and securely tighten the hub nuts to the specified torques. If the non-turn washers are installed to one side only, or if the hub nuts are not tightened sufficiently, the non-turn washer may fall out, which could cause the hub axle to rotate and the cassette joint to turn. This may then cause the handlebars to be accidentally pulled by the shifting cable, and an extremely serious accident could result.
  - Obtain and read the service instructions carefully prior to installing the parts. Loose, worn, or damaged parts may cause serious injury to the rider. We strongly recommend only using genuine Shimano replacement parts.
  - Check that the wheels are fastened securely before riding the bicycle. If the wheels are loose in any way, they may come off the bicycle and serious injury may result.
  - Read these Technical Service Instructions carefully, and keep them in a safe place for later reference.

- CAUTION** – To avoid serious injuries:
- Avoid continuous application of the brakes when riding down long slopes, as this will cause the internal brake parts to become very hot, and this may weaken braking performance. It may also cause a reduction in the amount of brake grease inside the brake, and this can lead to problems such as abnormally sudden braking.
  - Spin the wheel and confirm that the braking force of the coaster brake is correct.

- If the brakes are used frequently, the brake drum may become hot. Do not touch the brake drum for at least 30 minutes after you finish riding the bicycle.

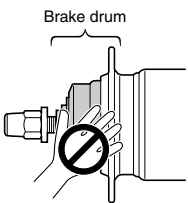

NOTE:

- You can shift gears while pedaling, but on rare occasions the pawls and ratchet inside the hub may produce some noise afterwards as part of normal gear shifting operation.
- If you place your foot on a pedal and move the bicycle backwards, a clicking will be felt in the pedal. This is normal and is not a sign of a malfunction.
- The CJ-NX10 cassette joint should only be used with sprockets from 16T to 23T.
- If the wheel becomes stiff and difficult to turn, you should replace the brake shoes or lubricate with grease.
- Do not apply any lubricant to the inside of the hub, otherwise the grease will come out.
- You should periodically wash the sprockets in a neutral detergent and then lubricate them again. In addition, cleaning the chain with neutral detergent and lubricating it can be a effective way of extending the useful life of the sprockets and the chain.
- If the chain keeps coming off the sprockets during use, replace the sprockets and the chain.
- Parts are not guaranteed against natural wear or deterioration resulting from normal use.
- For maximum performance we highly recommend Shimano lubricants and maintenance products.
- For any questions regarding methods of handling or adjustment, please contact the place of purchase.

SG-7C26  
SG-7C18  
SG-7C16  
CJ-NX10

SI-7C26B

Inter-7 Hub  
with Coaster Brake

Cassette Joint

Technical Service Instructions



Be sure to read these service instructions in conjunction with the service instructions for the Inter-7 shifting lever before use.

Installation of the sprocket to the hub

Place right hand dust cap C onto the driver on the right side of the hub body. Next, install the sprocket and secure it in place with the snap ring.

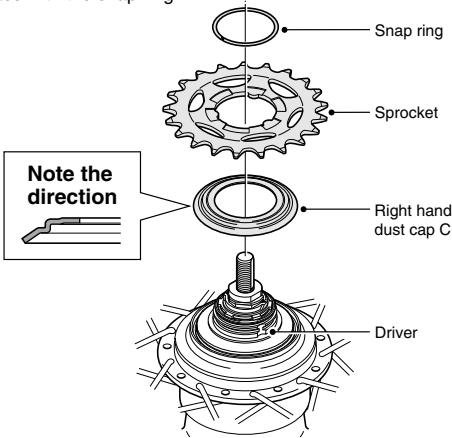

Installation of the cassette joint to the hub

- Install the driver cap to the driver to the right side of the hub body. Next, turn the cassette joint pulley in the direction of the arrow so that the yellow ● mark is aligned with the yellow ▲ mark, and then align the yellow ▲ marks on the cassette joint with the yellow ▲ marks on the right side of the hub body.

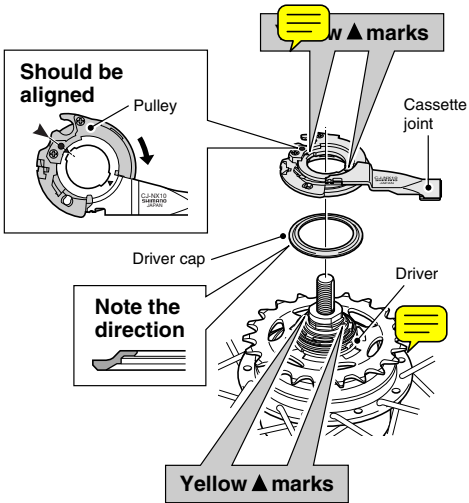

- 1) Secure the cassette joint to the hub with the cassette joint fixing ring. When installing the cassette joint fixing ring, align the yellow ● mark with the yellow ● mark on the cassette joint pulley.

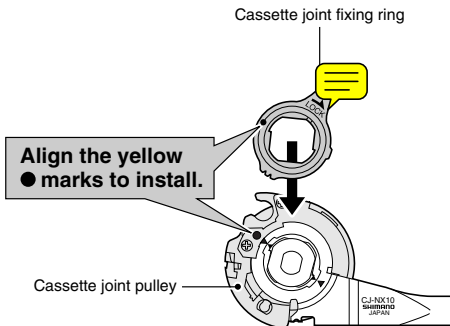

- 2) After installing the cassette joint fixing ring, turn it 45° clockwise.

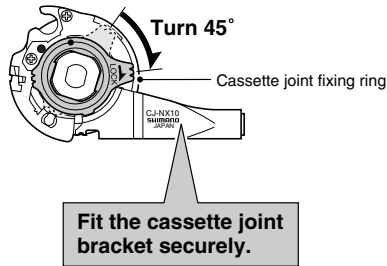

Installation of the hub to the frame

1. Mount the chain on the sprocket, and then set the hub axle into the fork ends.

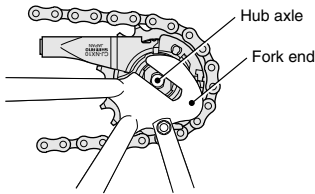

2. Place the non-turn washers onto the right side and left side of the hub axle. At this time, turn the cassette joint so that the projecting parts of the non-turn washers fit into the grooves of the fork ends. If this is done, the cassette joint can be installed so that it is almost parallel to the chainstay.

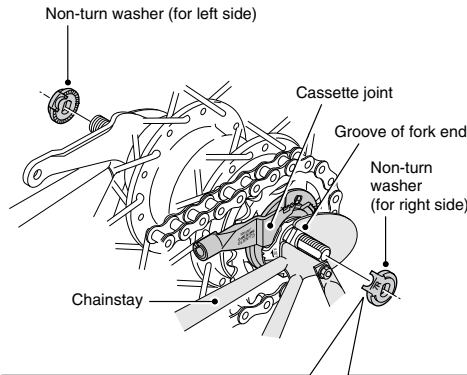

- Different types of left and right non-turn washers are available for use with standard and reversed fork ends. Use whichever non-turn washers are suitable.

| Fork end                   | Non-turn washer |          |               |
|----------------------------|-----------------|----------|---------------|
|                            | Mark/Color      |          | Size          |
|                            | Right           | Left     |               |
| Standard                   | 7R/Black        | 7L/Gray  | 20° ≤ θ ≤ 38° |
| Reversed                   | 6R/Silver       | 6L/White | θ = 0°        |
| Reversed (full chain case) | 5R/Yellow       | 5L/Brown | θ = 0°        |



- The projecting parts should be on the fork end side.
- Install the non-turn washers so that the projecting parts is securely in the fork end grooves on either side of the hub axle.

3. Take up the slack in the chain and secure the wheel to the frame with the cap nuts.

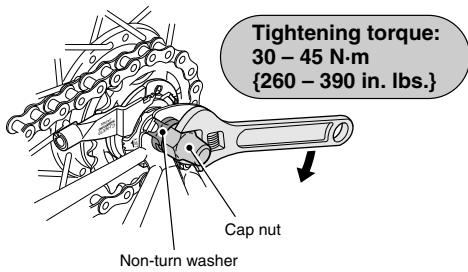

4. Fix the brake arm securely to the chainstay with the brake arm clip.

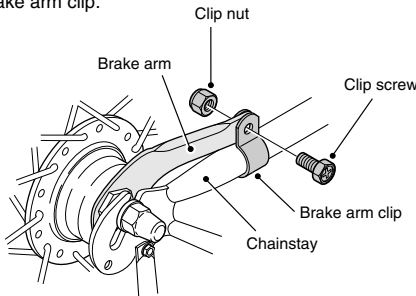

Note:

- When installing the brake arm clip, securely tighten the clip screw while holding the clip nut with a 10 mm spanner.

Tightening torque:  
2 – 3 N·m {17 – 26 in. lbs.}

- After installing the brake arm clip, check that the clip screw protrudes about 2 – 3 mm from the surface of the clip nut.

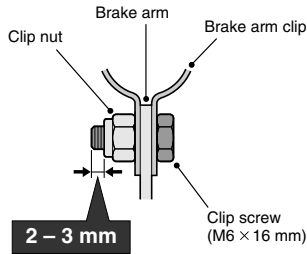

5. Before using the Coaster Brake, check that the brake works properly and that the wheel turns smoothly.

These service instructions explain how to use and maintain the Shimano bicycle parts which have been used on your new bicycle. For any questions regarding your bicycle or other matters which are not related to Shimano parts, please contact the place of purchase or the bicycle manufacturer.

These service instructions are printed on recycled paper.

Please note: Specifications are subject to change for improvement without notice. (English)

SHIMANO®

SHIMANO AMERICAN CORPORATION  
One Holland, Irvine, California 92618, U.S.A. Phone: +1-949-951-5003

SHIMANO EUROPE HOLDING B.V.  
Industrieweg 24, 8071 CT Nunspeet, The Netherlands Phone: +31-341-272222

SHIMANO INC.  
3-77 Oimatsu-cho, Sakai, Osaka 590-8577, Japan

# NEXUS 7-Speed Internal Hub w/Coaster Brake

## SG-7C16 Inter-7 Hub

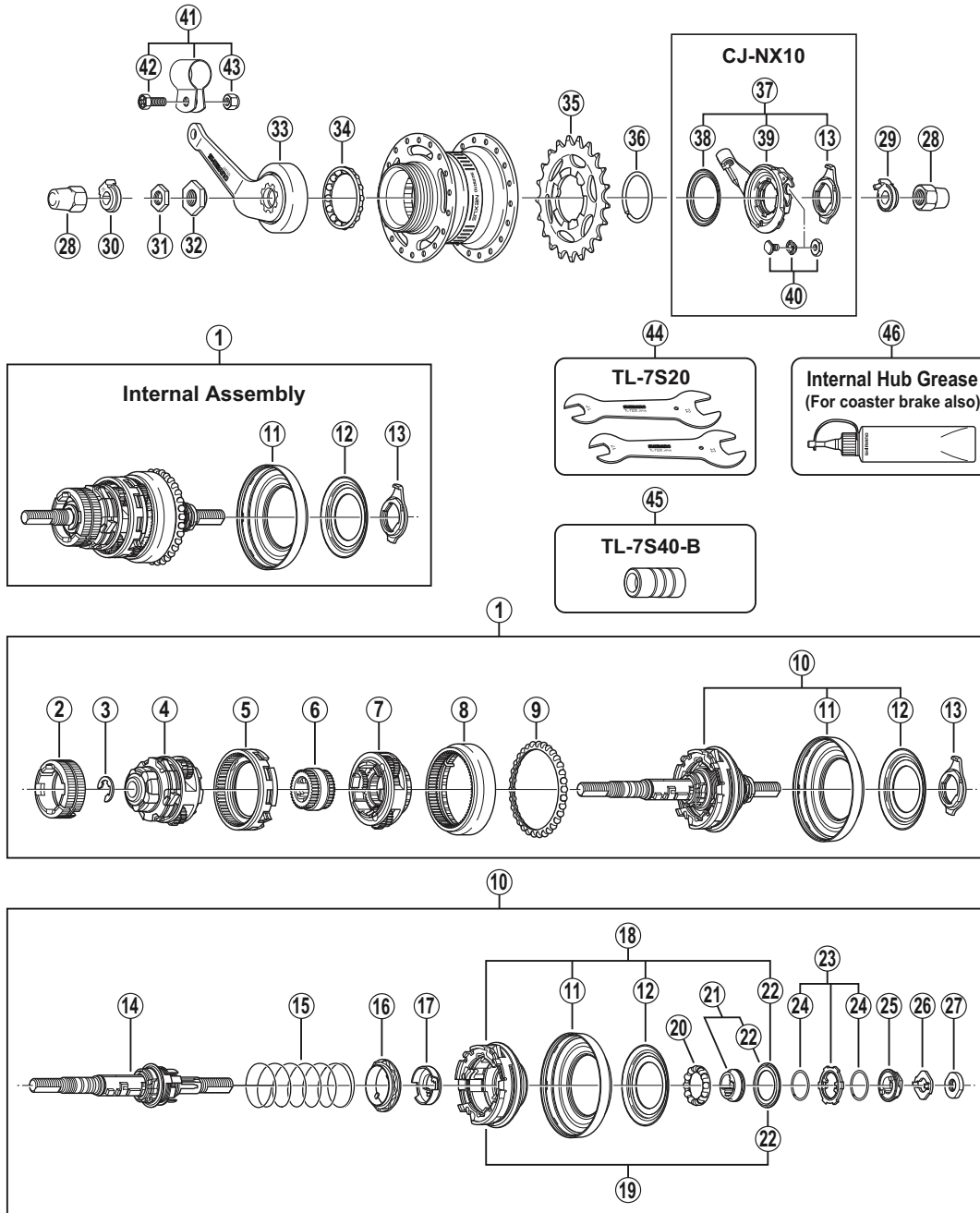

| ITEM NO. | SHIMANO CODE NO. | DESCRIPTION   |
|----------|------------------|---|
| * 1      | Y-35K 98010      | Internal Assembly (Axle Length 175.5 mm)                              |
| * 2      | Y-35K 98020      | Brake Shoe Unit   |
| 3        | Y-325 32000      | Stop Ring (φ9 mm)   |
| * 4      | Y-35K 98030      | Carrier Unit 2  |
| * 5      | Y-35K 98040      | Ring Gear Unit 2  |
| 6        | Y-33F 98060      | Sun Gear Unit 2 & 3   |
| 7        | Y-330 98060      | Carrier Unit 1  |
| * 8      | Y-35K 98050      | Ring Gear Unit 1  |
| 9        | Y-330 98070      | Ball Retainer H (3/16" x 29)  |
| * 10     | Y-35K 98060      | Axle & Driver Unit (Axle Length 175.5 mm) w/Right Hand Dust Cap B & C |
| * 11     | Y-35K 06000      | Right Hand Dust Cap B   |
| 12       | Y-33Z 26000      | Right Hand Dust Cap C   |
| 13       | Y-33Z 98020      | Cassette Joint Fixing Ring  |
| 14       | Y-34N 98030      | Axle Unit (Axle Length 175.5 mm)                                      |
| 15       | Y-330 24000      | Return Spring A   |
| 16       | Y-33Z 10000      | Gear Shifting Cam   |
| 17       | Y-33Z 11000      | Feed Cam  |
| * 18     | Y-35K 98070      | Driver Unit w/Right Hand Dust Cap B, C & Right Hand Cone Seal         |
| * 19     | Y-35K 98080      | Driver Unit w/Right Hand Cone Seal                                    |
| 20       | Y-330 91600      | Ball Retainer F (3/16" x 12)  |
| * 21     | Y-35K 98100      | Right Hand Cone w/Seal  |
| * 22     | Y-35K 07000      | Right Hand Cone Seal  |
| 23       | Y-33F 98040      | Driver Plate w/Seal   |
| 24       | Y-330 12000      | Driver Plate Seal   |
| 25       | Y-33E 98120      | Lock Washer   |
| 26       | Y-33Z 08000      | Stop Washer   |
| 27       | Y-33Z 07020      | Right Hand Lock Nut (3.4 mm)  |
| 28       | Y-314 14010      | Cap Nut (3/8")  |
| 29       | Y-33Z 20500      | Non-turn Washer 5R (Yellow)   |
|          | Y-33M 39600      | Non-turn Washer 6R (Silver)   |
|          | Y-33M 39700      | Non-turn Washer 7R (Black)  |
|          | Y-33M 39510      | Non-turn Washer 5L (Brown)  |
| 30       | Y-33M 39610      | Non-turn Washer 6L (White)  |
|          | Y-33M 39710      | Non-turn Washer 7L (Gray)   |
| 31       | Y-321 38040      | Lock Nut (3.5 mm)   |
| 32       | Y-335 48110      | Stop Nut  |
| * 33     | Y-35K 98090      | Brake Arm Unit  |
| 34       | Y-330 98110      | Ball Retainer B (3/16" x 16)  |
| 35       | Y-322 03420      | Sprocket Wheel 18T  |
|          | Y-322 03520      | Sprocket Wheel 19T  |
|          | Y-322 03620      | Sprocket Wheel 20T  |
|          | Y-330 60000      | Sprocket Wheel 21T  |
|          | Y-330 60100      | Sprocket Wheel 22T  |
| 36       | Y-321 20100      | Snap Ring C   |
| 37       | Y-74Y 98050      | CJ-NX10 Cassette Joint Unit   |
| 38       | Y-74Y 18000      | Driver Cap  |
| 39       | Y-74Y 93100      | CJ-NX10 Cassette Joint  |
| 40       | Y-74Y 98060      | Inner Cable Fixing Bolt Unit for CJ-NX10                              |
| 41       | Y-33F 98090      | Brake Arm Clip Unit (5/8")  |
|          | Y-33F 98100      | Brake Arm Clip Unit (3/4")  |
| 42       | Y-75M 06000      | Clip Screw (M6 x 16)  |
| 43       | Y-317 27200      | Clip Nut  |
| 44       | Y-130 98900      | TL-7S20 Hub Spanner (17 mm x 22 mm) 2 pcs.                            |
| 45       | Y-308 89000      | TL-7S40-B Right Hand Cone Tool  |
| 46       | Y-041 20800      | Internal Hub Grease (Net. 100g)                                       |